

Waterproof Self Seal Stack Assembly

POUR CONCRETE ON WOOD FORM
FOR FLOORS

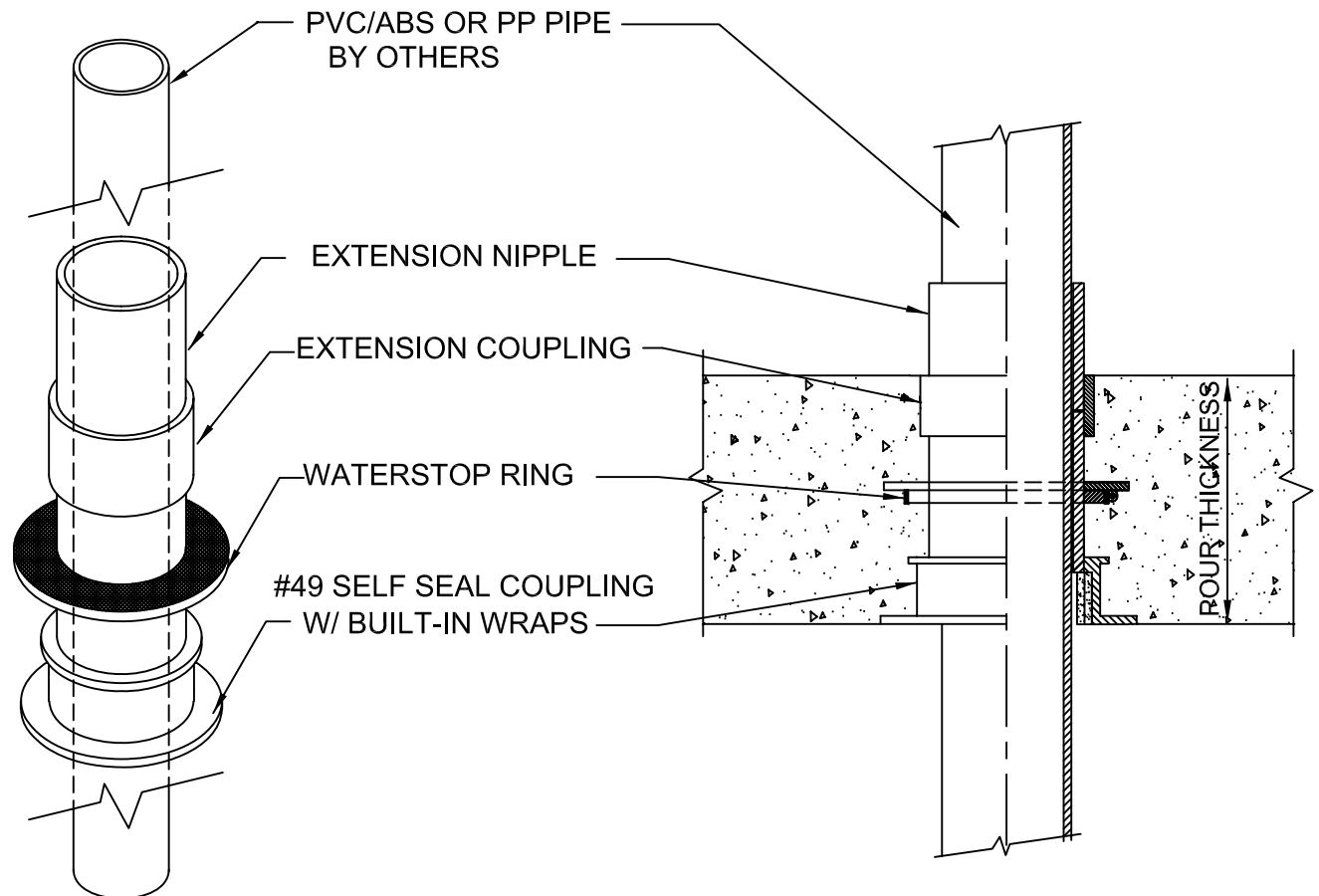

IMPORTANT NOTES :

1. Use nails through flange holes to mount the flange to the deck.
2. Solvent cement the sleeve assembly with the Ring, Coupling & Cap into the flange.
3. After concrete is poured, remove protective cap that is flush with the concrete floor.
4. Install the special top extension into the top coupling to extend 2" above finish floor.
5. Insert the through pipe from the bottom side of the Black sleeve up through the extension pipe.
6. After the pipe is passed through, swab around the top pipe and the sleeve extension with solvent cement to attach and secure the pass through piping to the sleeve

Option: If the plastic pass through pipe is not PVC a ProSet Riser Clamp can be used to secure the pipe instead of the solvent cement.



W.H. Directory Reference 00 Edition
Firestop Device
W.H. Design No. PS/PHV 180-03
F Rating 3 Hrs.



PROSET[®]
SYSTEMS
FIRESTOP PENETRATOR™

DATE :
1-10-06

DRG . NO .
C-9049-ACR